

BONGO PD INSTALLATION INSTRUCTIONS

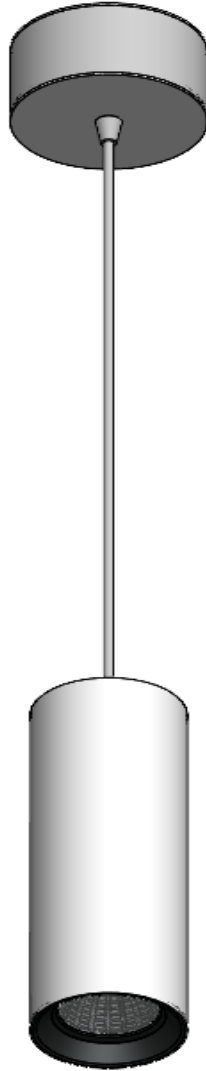

WARNING - RISK OF FIRE AND ELECTRICAL SHOCK. FIXTURE MUST BE INSTALLED BY A QUALIFIED ELECTRICIAN ONLY. FIXTURE IS INTENDED FOR INSTALLATION IN ACCORDANCE WITH THE NATIONAL ELECTRICAL CODE, LOCAL AND FEDERAL SPECIFICATIONS. DISCONNECT POWER AT ELECTRICAL PANEL BEFORE SERVICING. RETAIN THESE INSTRUCTIONS FOR MAINTENANCE REFERENCE.

FIXTURE INSTALLATION

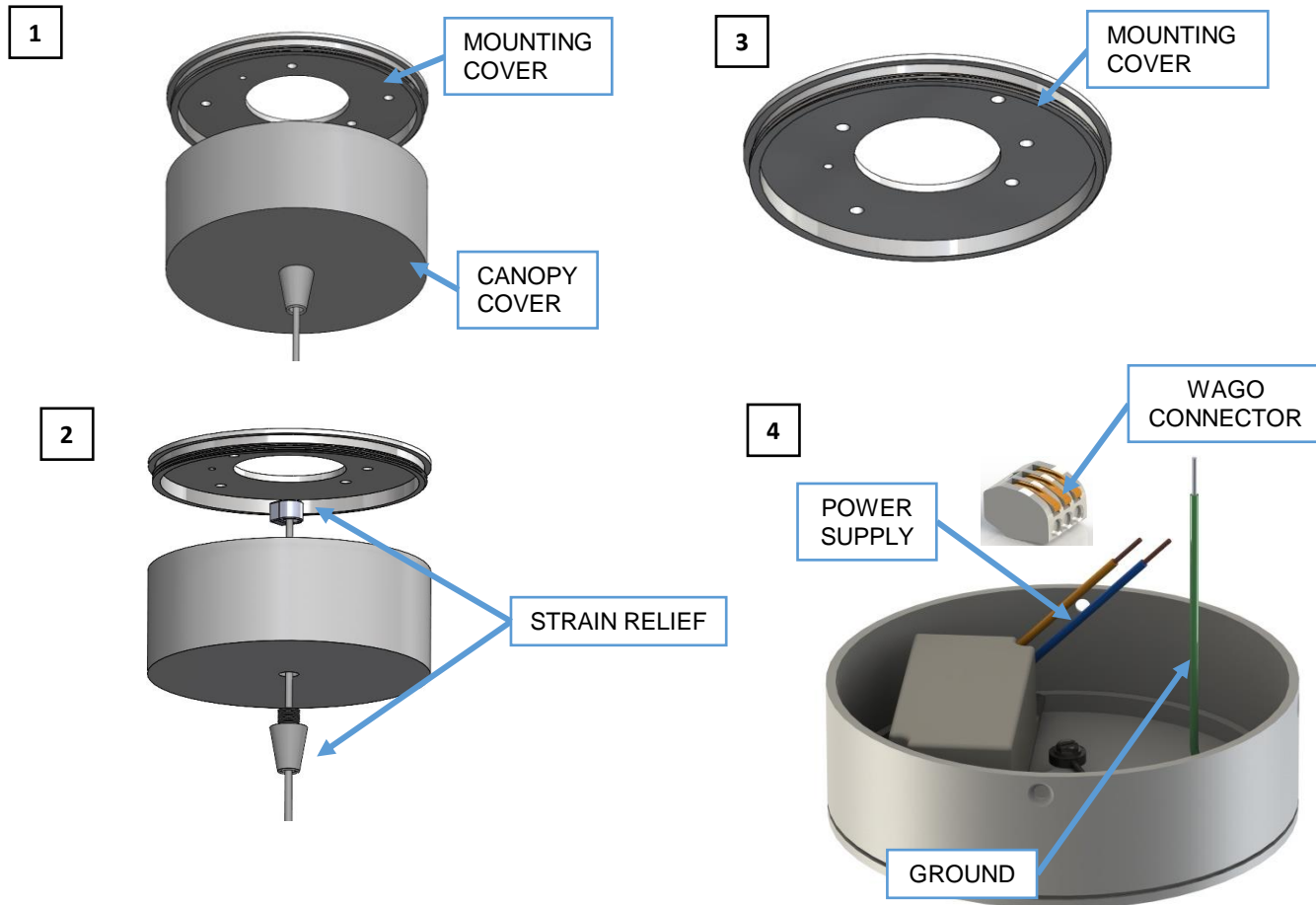

1. TO ADJUST FIXTURE HEIGHT,
 - REMOVE THE CANOPY COVER OF THE BONGO PENDANT BY UNSCREWING IT. (FIG 1)
 - LOOSEN THE STRAIN RELIEF ON THE CANOPY COVER AND MOVE IT ALONG THE POWER CORD TO THE DESIRED HEIGHT.(FIG 2) DISCONNECT THE WIRE THAT IS CONNECTED TO DRIVER USING WAGO CONNECTOR.
 - CUT AND STRIP THE CABLE TO REVEAL 2 WIRES, STRIP THE 2 WIRES AND RE-CONNECT TO THE DRIVER USING THE WAGO CONNECTORS ALREADY IN THE CANOPY, RED TO RED AND BLACK TO BLACK. TIGHTEN THE STRAIN RELIEF TO LOCK THE FIXTURE IN POSITION AND REATTACH THE CANOPY COVER TO THE MOUNTING COVER.
2. UNSCREW THE MOUNTING COVER FROM THE CANOPY AND ATTACH IT TO A STANDARD J-BOX ON THE CEILING. (FIGURE 3 AND 5)
3. CONNECT MAIN POWER LINES TO THE POWER SUPPLY USING PROVIDED WAGO CONNECTORS. CONNECT GROUND TO GREEN ON THE FIXTURE, NEUTRAL TO WHITE/BLUE ON THE FIXTURE AND HOT TO BLACK/BROWN ON THE FIXTURE. (FIGURE 4)
4. ATTACH CANOPY COVER TO MOUNTING COVER. (FIGURE 5)
5. TURN ON POWER TO LIGHT FIXTURE.